

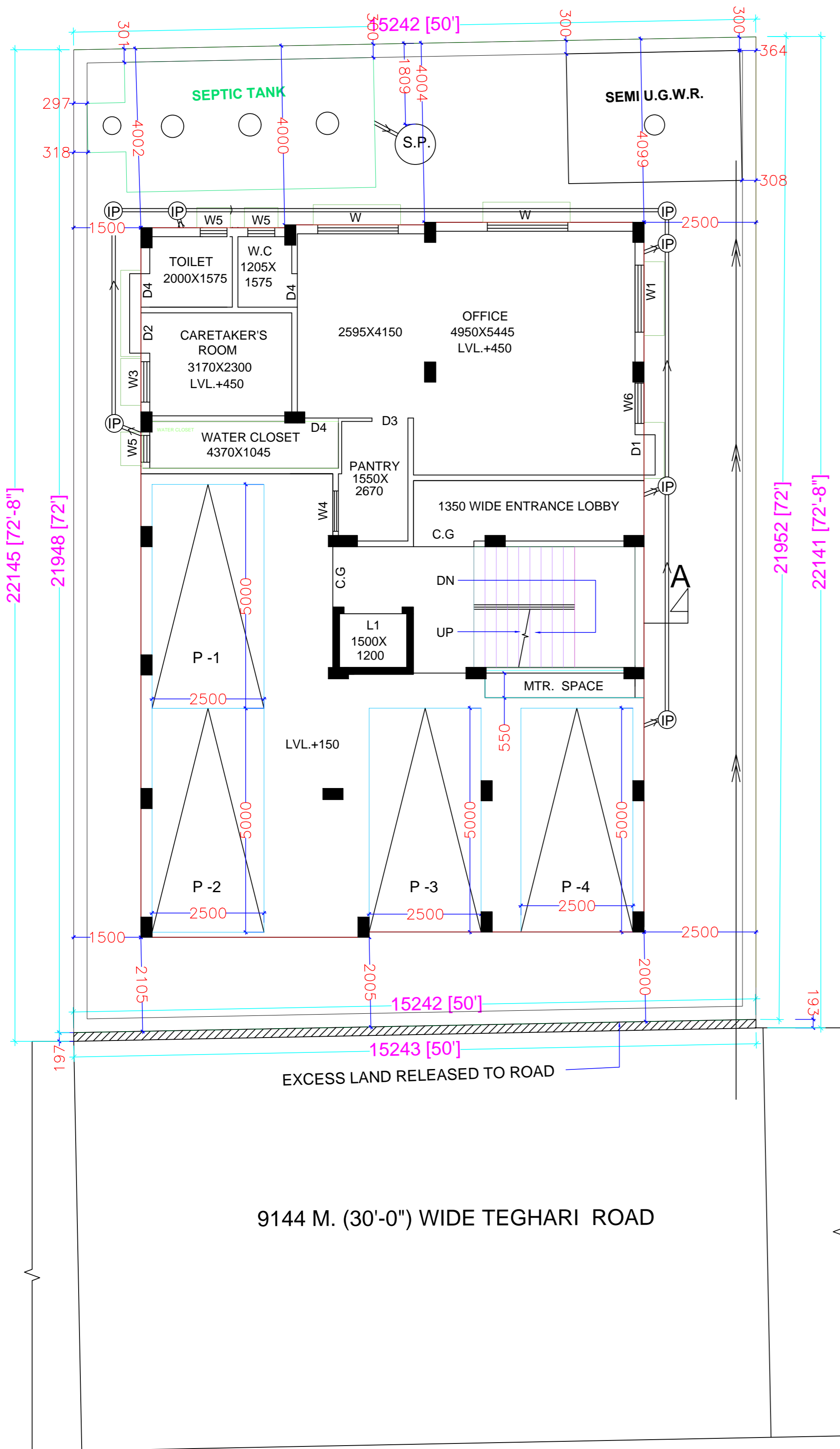

**SEWER AND WATER CONNECTION PLAN OF PROPOSED G+IV STORIED RESIDENTIAL CUM COMMERCIAL BUILDING PLAN AT MOUZA - JAGANNATHPUR ,
J.L. NO. - 51, L.R. DAG NO.- 602, L.R. KHATIAN NO. -2653 & 2654, HOLDING NO. - 573 ,ROAD - TEGHARI ,WARD NO. - 08,
P.S. - SONARPUR PRESENTLY NARENDRAPUR, DIST-24 PGS.(S), UNDER RAJPUR SONARPUR MUNICIPALITY.**

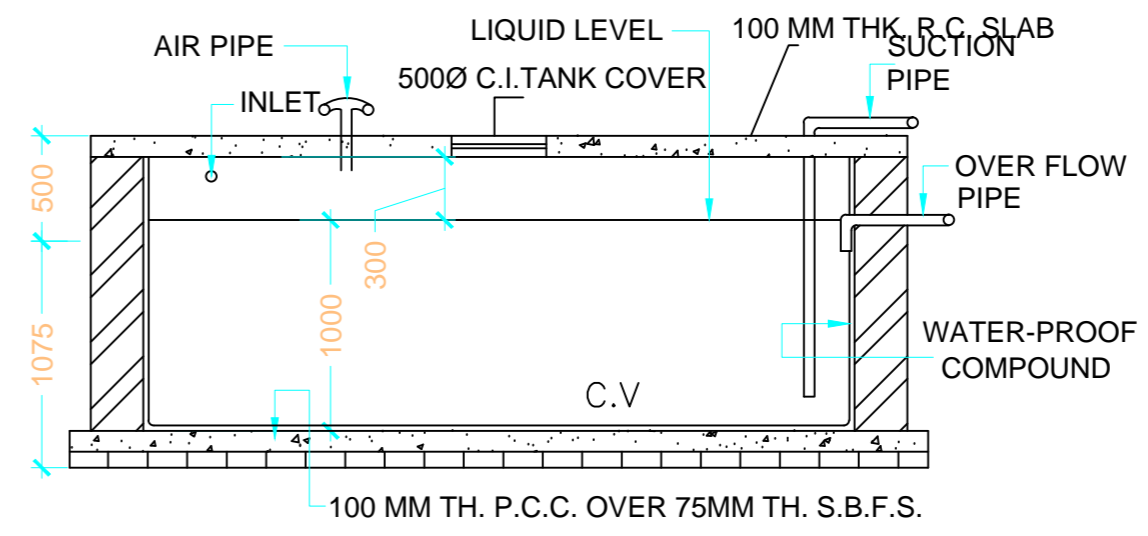

GROUND FLOOR PLAN
SCALE - 1:1



SECTION - YY
SCALE - 1:50

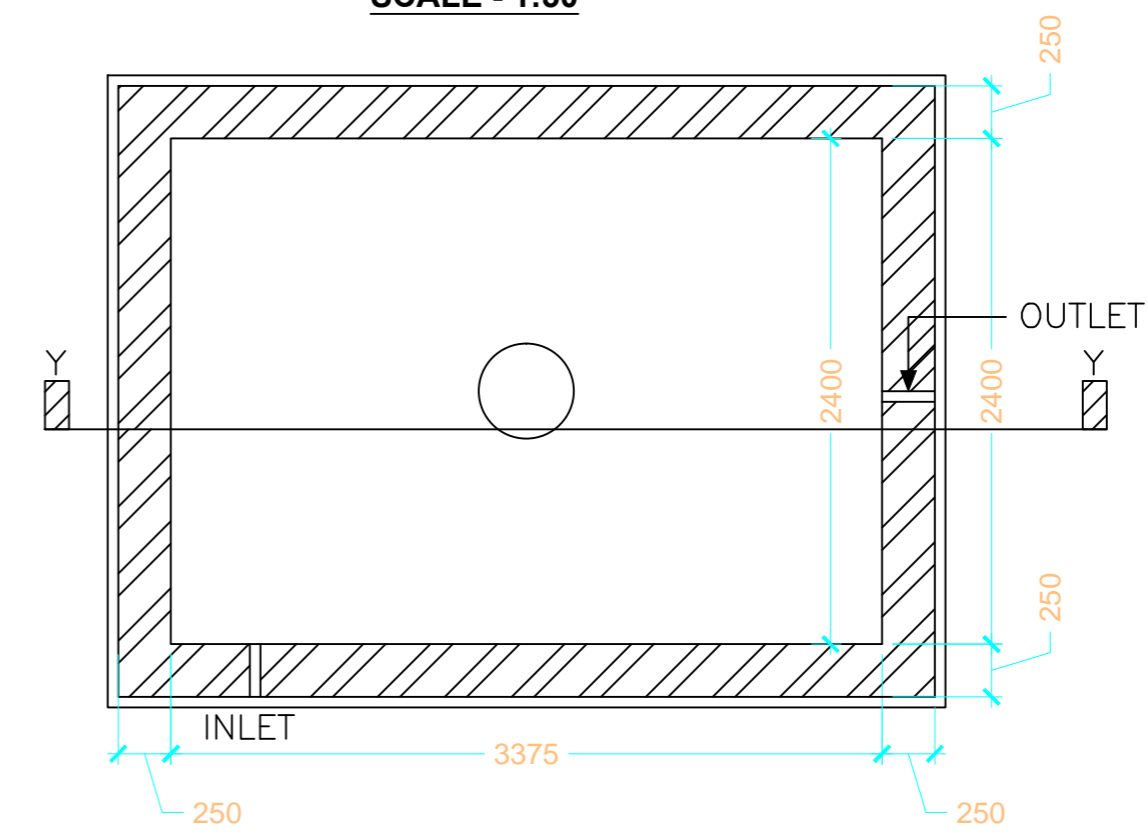

DETAIL OF S.U. WATER RESERVOIR
CAPACITY :- 8100 LTRS
SCALE - 1:50

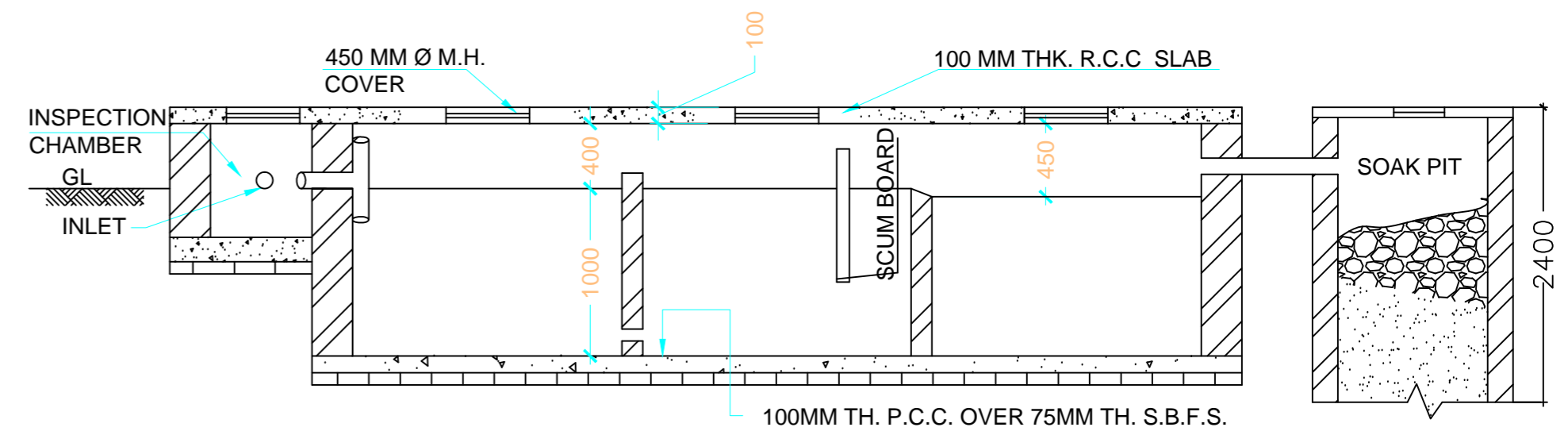

L. SEC. OF SEPTIC TANK
SCALE - 1:50

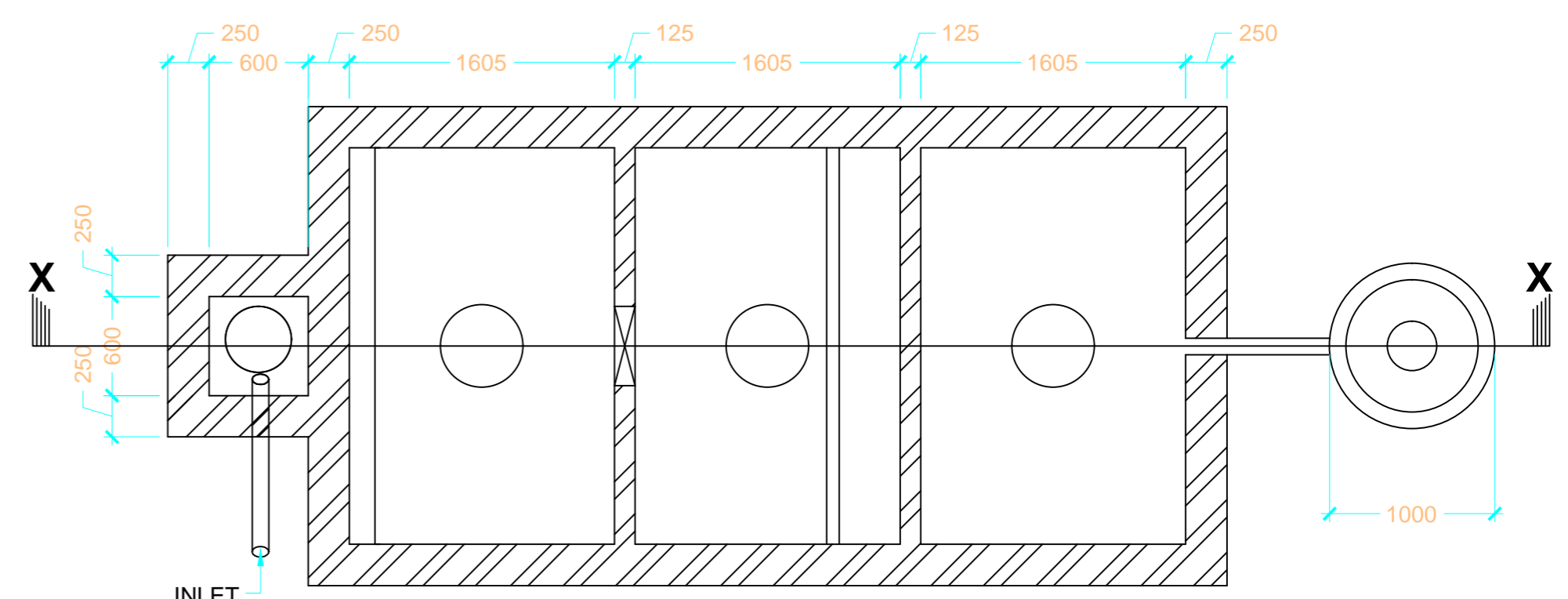

SEPTIC TANK
60 USER
SCALE - 1:50

SOAK PIT
SCALE - 1:50

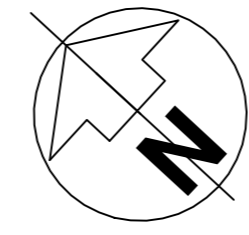

SYED WASEH NAZAKAT
L.B.S. - 500
NAME OF L.B.S. CL-I

SANTONU DAS
NAME OF OWNER